

About the Venue (IIT Hyderabad)

Floor plan

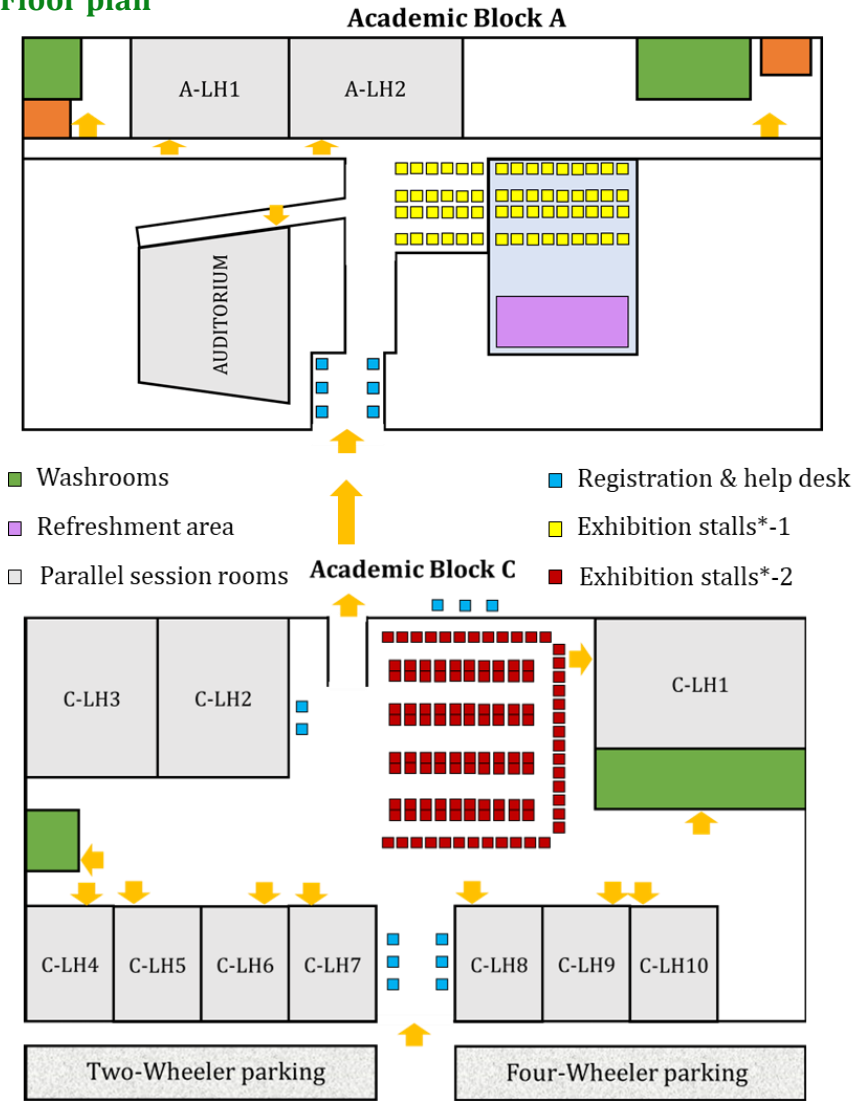

- Washrooms
- Refreshment area
- Parallel session rooms
- Registration & help desk
- Exhibition stalls*-1
- Exhibition stalls*-2

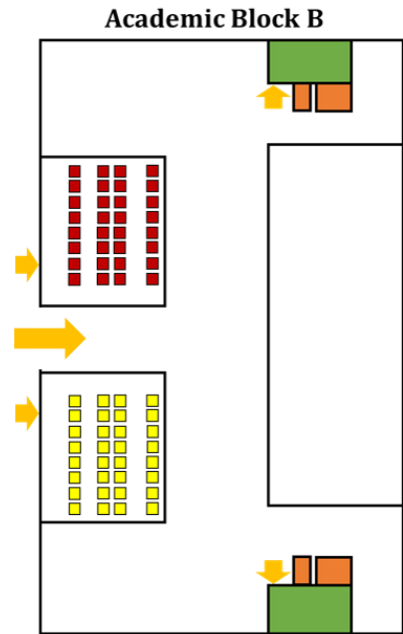

* Stall of size 1.5m x 1.5m.

Way to IIT Hyderabad

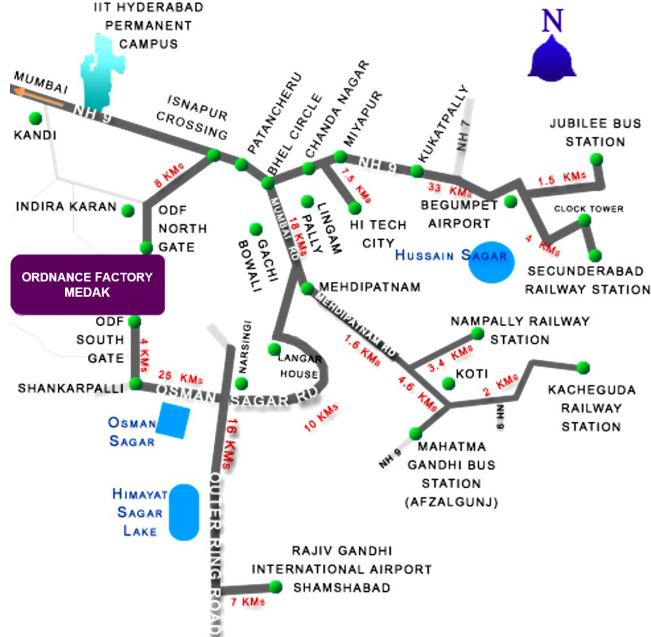

Academic Block A



Academic Block B



Academic Block C



Auditorium

<https://mae.iith.ac.in/sice22/>